

TABULATION BLOCK	
PART NUMBER	DIM X
P100-1-096-01	17.5 ± .05
P100-1-096-02	30.0 ± .05
P100-1-096-03	42.5 ± .05
P100-1-096-04	55.0 ± .05

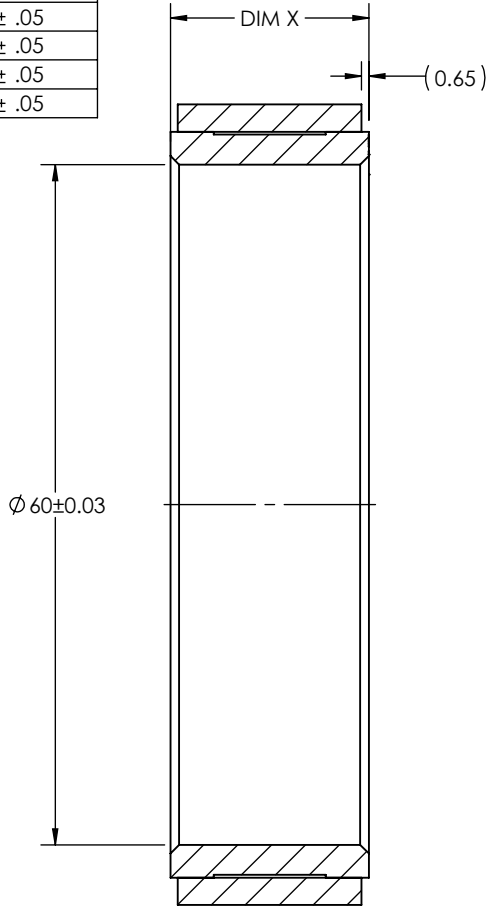

SECTION A-A

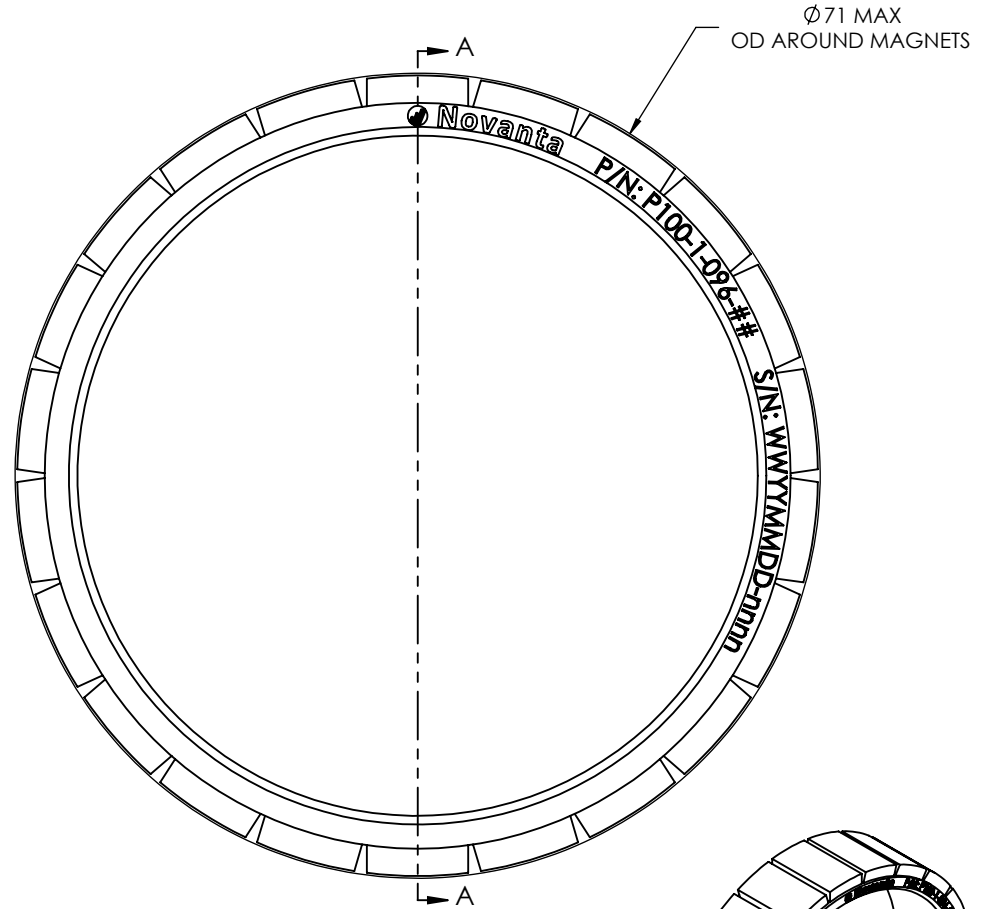

NOTES: (UNLESS OTHERWISE SPECIFIED):

1. ROTOR MOUNTING REQUIREMENTS, REFER TO P100-1-051-01 DOCUMENT
2. ESTIMATED MASS AND OTHER SPECIFICATIONS REFER TO P100-1-052-01 DOCUMENT.
3. HIGHLY MAGNETIZED ASSEMBLY, HANDLE WITH CARE TO AVOID DAMAGE OR INJURY.
4. SHALL BE ROHS AND REACH COMPLIANT TO LATEST VERSION OF REGULATORY SPECIFICATION.
5. MATERIAL AND SURFACE TREATMENT CERTIFICATIONS SHALL BE PROVIDED WITH EACH LOT.

REV	DCN	DESCRIPTION OF CHANGE	DATE	SIGN
2	007805	SEE DCN	2021-DEC-20	RMH
1	007775	INITIAL RELEASE	2021-NOV-23	AFT

CONFIDENTIAL

THIS DRAWING CONTAINS PROPRIETARY INFORMATION OF CELERA MOTION AND MAY NOT BE IN WHOLE OR IN PART, DUPLICATED OR DISCLOSED OR USED FOR MANUFACTURE OF ANY PART DISCLOSED HEREIN WITHOUT THE PRIOR WRITTEN PERMISSION OF CELERA MOTION.



DRAWN IAW ASME Y14.5-2009

X. ± 1.25 X.XX ± 0.125
X.X ± 0.25 X.XXX ± 0.0125
ANGULAR: X ± 1°

UNITS
MM

TITLE: **ROTOR INTERFACE DRAWING**

MATERIAL: N/A	DRWN: A.TERA0	8/10/2021	DRAWING NUMBER:	REV
TREATMENT: N/A	CHKD: R. HORN	11/10/2021	P100-1-096-XX	2
SURFACE FINISH: N/A	APPVD: S DAWSON	11/10/2021	SCALE: 1:1 (DO NOT SCALE DRAWING)	SIZE: A SHEET 1 of 1